

High Voltage Capacitors

MKT 210-214 AXIAL

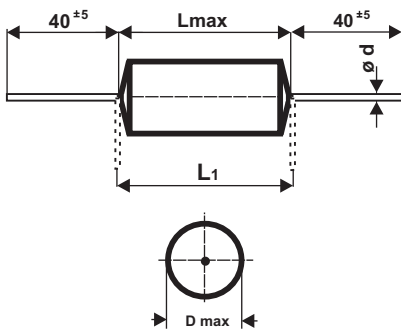
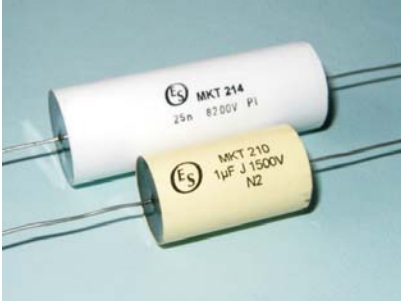

d (mm) = 0,8; or on request

Maximum dissipation factor tg δ

kHz	C ≤ 0,1µF	0,1µF till 1µF	> 1 µF
1	0,008	0,008	0,010
10	0,015	0,015	
100	0,025		

Construction of capacitors:

Metallized polyester film capacitors noninductive construction cylindrical shape, self-healing ability. Leads: tinned cooper wire. Surface coating by polyester film tape wrapped, epoxy resin sealed. Flame retardant construction available upon request also UL 94 V - 0. Insulated construction of MKT 212, MKT 213, MKT 214 on request.

Reference standards: EN 130 000, IEC 60384-1, IEC 60384-2

Nominal capacitance:

Nominal capacitance values are based on the E6 serie in accordance to IEC 63 or arbitrary values in capacitance range on request.

Nominal capacitance tolerance: ± 20%(M), ± 10%(K), ± 5%(J) or arbitrary tolerances on request

Climatic Resistivity Category: 55/85/56

Upper Operating Temperature:

The max. temperature measured on the case surface at which the capacitor can work continually +85°C.

Rated voltage UR :

The rated voltage is the voltage for which the capacitor has been designet. It is the max. direct voltage or peak value of pulse voltage which may be applied continuously to a capacitor.

Permissible AC Voltage:

The capacitors are constructed for applications with DC voltage basically. If the capacitor is used in circuits with sine wave voltage the effective value must not exceed the permissible AC voltage at 50/60 Hz. For the operation at higher frequencies must be the amplitude correspondingly reduced. The surface temperature of the capacitor must not exceed +85°C.

Test voltage:

Capacitor are tested by voltage $U_T = 1,25 \times U_R$ for 2 sec. at +25°C ± 5°C.

Insulation resistance Ris:

The insulation resistance is expressed in MΩ and is measured at the specified voltage 100 VDC after 1 minute charge.

C ≤ 0,33 µF **Ris min. 30 000 MΩ**
C ≥ 0,47 µF **tis min. 10 000 sec.**

Time Constant tis:

The time constant is to express the quality insulance for higher capacities and is expressed in seconds with the following formula: $tis = Ris \cdot C$ [sec;MΩ;µF]

Max. permissible pulse rise time:

$$dU/dt \leq 1V/\mu\text{sec}$$

Type	MKT 210	MKT 211	MKT 212	MKT 213	MKT 214
Nom. Voltage UR = DC/AC [V]	1600 300	2500 350	3900 400	6300 450	8200 500
Capacitance C	Maximal dimensions [mm]				
	D x L	D x L	D x L	D x L	D x L
1000 pF				6 x 36	7,5 x 36
1500				7 x 36	8,2 x 36
2200			6 x 36	8 x 36	10 x 36
3300			7 x 36	9 x 36	11,5 x 36
4700			8 x 36	11 x 36	13 x 36
6800			9 x 36	13 x 36	16 x 36
0,010 µF		6,5 x 36	10,6 x 36	15 x 36	20,5 x 36
0,012		6,7 x 36	11,6 x 36	17 x 36	18 x 41
0,015		7 x 36	13 x 36	19 x 36	20 x 41
0,020		8 x 36	15 x 36		12,2 x 56
0,022		8,2 x 36	16 x 36		14,2 x 56
0,025		9 x 36	17 x 36		14,7 x 56
0,033		10,2 x 36	20,5 x 36		15,8 x 56
0,047	6 x 36	12,5 x 36	12,5 x 56		18,5 x 56
0,050	6,2 x 36	13 x 36	14,4 x 56		21,5 x 56
0,068	7 x 36	15 x 36	15 x 56		22 x 56
0,10 µF	8,2 x 36	18 x 36	17 x 56		25 x 56
0,15	9,8 x 36	20,5 x 36	21 x 56		31 x 56
0,22	11,5 x 36	24 x 36	25,5 x 56		
0,25	12,5 x 36	26 x 36	31 x 56		
0,33	14 x 36		33 x 56		
0,47	16,6 x 36				
0,50	17,2 x 36				
0,68	20,5 x 36				
1,0 µF	24 x 36				

This capacitors are not suitable for across the line applications

Warning! The manufacturer is not responsible for any damages, caused by the improper installation and application. Before using the capacitor in any application, pleas, read carefully this technical data-sheet.